

PRESENTING

club
verde

A 23,500 SFT UBER 5-star club exclusively handcrafted
for privileged residents @ LIFE BY THE LAKE

Virtual Orientation of Club Verde



club
verde

TOP VIEW

club
verde

club
verde

FRONT VIEW





LOBBY

**GROUND
FLOOR**



LIFT LOBBY



BUSINESS CENTRE



MULTI-PURPOSE HALL



GOLF →
SIMULATOR

OPEN LIBRARY



GYM



MINI THEATRE



INDOOR GAMES

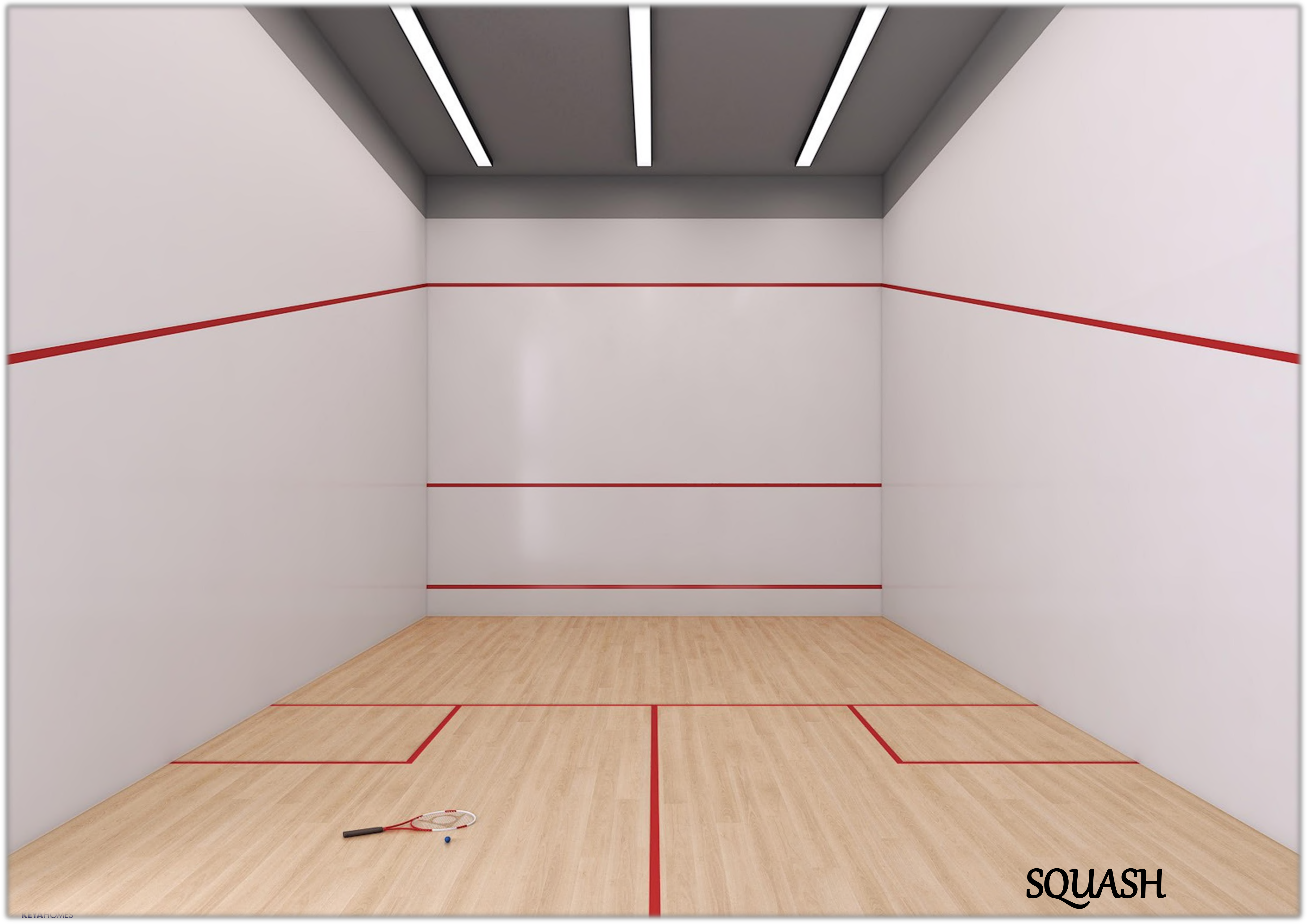

SQUASH



60'

34'

25.7'

BADMINTON



HO GOLF

PUTTING
Player 1
HO GOLF

SHOT INFO
Distance to Pin
62.9 ft.
Lie
GREEN
Pin Altitude
-1.1 ft.
Avg. Dist. to Pin
0.0 ft.
Last Shot
0.0 ft.
Last Dist. to Pin
62.9 ft.

GOLF SIMULATION



SWIMMING POOL

GROUND FLOOR

- 1. LOBBY
- 2. MULTIPURPOSE HALL
- 2A. PANTRY
- 2B. HANDWASH
- 3. GROCERY STORE
- 4. LOUNGE
- 5. BUSINESS CENTRE
- 6. LIFT LOBBY



FIRST FLOOR

- 1. OPEN LIBRARY
- 2. BADMINTON
- 3. POOL TABLE
- 4. SQUASH



SECOND FLOOR

- 1. LOUNGE
- 2. INDOOR GAMES
- 3. GOLF SIMULATION



THIRD FLOOR

- 1. GYM
- 2. YOGA ROOM
- 3. STEAM
- 4. SAUNA
- 5. JACUZZI
- 6. MINI THEATRE



Terrace Floor

1. OPEN TO SKY GYM
2. KID'S POOL
3. INFINITY HEATED POOL
4. DECK
5. CHANGE ROOMS
6. SIGNATURE LANDSCAPE

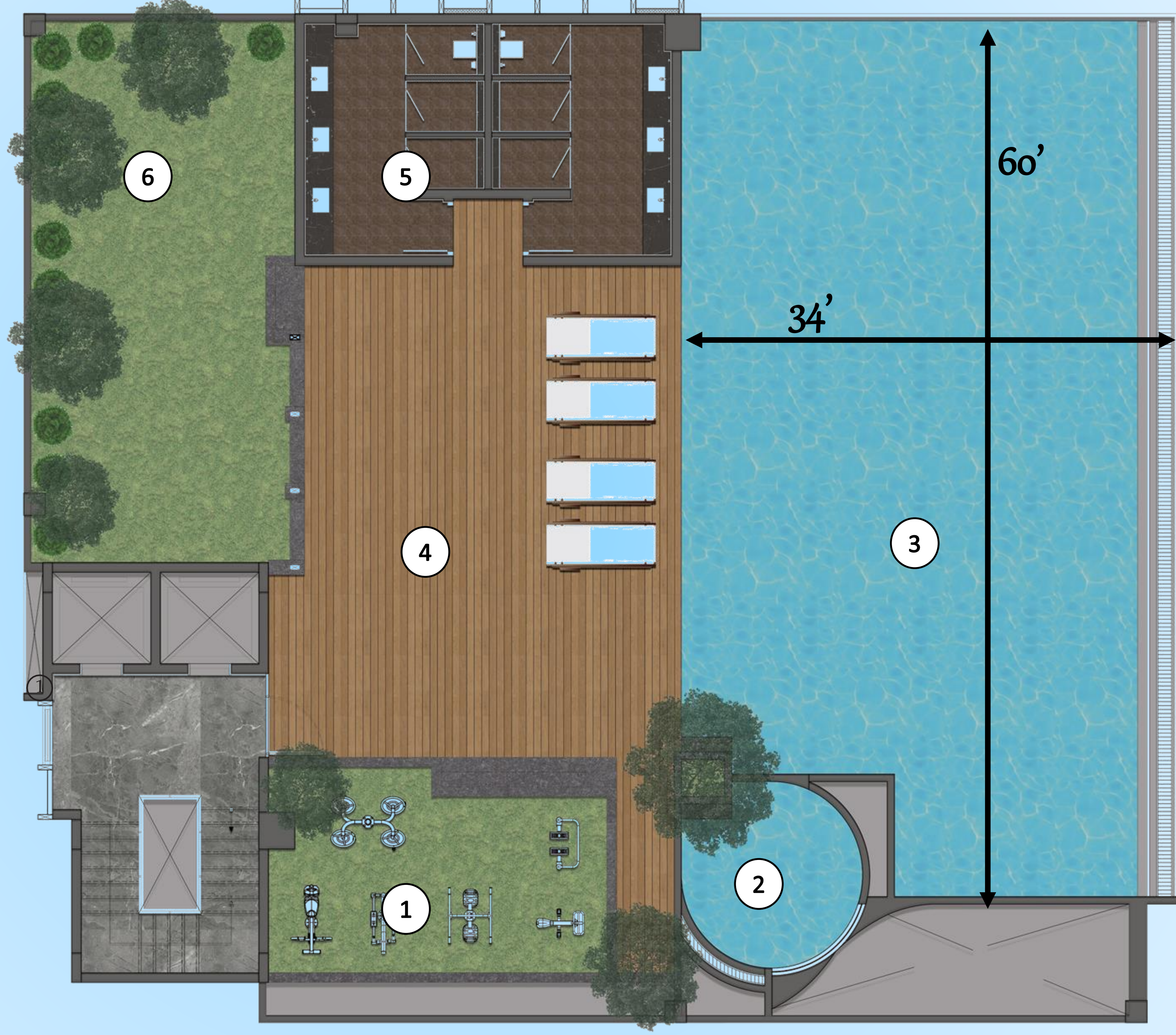

DISCLAIMER

The images used in the presentation have been rendered for the project to help us understand the look and feel of the club house and the project. The actual execution has been done/is being done on the project as per approved plan and material specification as mentioned in agreement to sale.

Do note that the club house is being built for fun/enjoyment/entertainment and no-where commits to professional level set up for any of the sports/amenities.

For any query/information – reach us at sales@keyahomes.in or call at +91 888 444 0201